

144.511.000
Round tube Ø48 1000 mm

technical data

Protection class	IP 54/EN 60529
Colour	Silver Silver
Weight (g)	3600 g
Country of manufacture	Germany
Customs tariff number	73089098

taraSMART

THE MODERN SUSPENSION ARM SYSTEM FOR LIGHT TO MEDIUM LOADS

IP 54

taraSMART is a sophisticated suspension arm system for modern machine construction. The perfect symbiosis of technical design and sophistication. It offers sufficient space for routing HDMI or DVI cables, or network plugs. Installation is quick and easy, thanks to the familiar, tried and tested technology. The coupling variants of the system enable the connection of both narrow and deep control enclosures. Thanks to the Ø48 bracket, the straightforward connection of panel PCs with a round tube frame can take place without additional adapters.

Load-bearing capacity

embed_LBC_diagram_start_#etc/traglast/taraSMART-load_capacity-EN.jpg#embed_LBC_diagram_end

Principle

Economic, compact and elegant designer suspension arm system for light to medium loads

Additional information

Connection of HMI/control enclosures from leading manufacturers with a round tube frame (such as Siemens, Beckhoff, B&R) possible

The generous cable routing offers an optimum connection with all interfaces, sufficient space is available for a range of cables and connectors

Horizontal alignment of the complete system assembly possible at all joints!

Material/coating

Die-cast aluminium alloy, powder coated RAL 7035 light grey

Optional: Special colours

Support profiles: Extruded aluminium profile, silver anodised

Ø48 round tubes: steel, silver coated

Covers: Thermoplast, RAL 7016, anthracite grey

Gasket

Chloroprene O-ring gasket (CR), temperature resistance: -30°C to +90°C

Cable routing

Suitable for HDMI, patch cables, DVI, USB, cold-device plugs, etc.

Ingress protection

IP 54 / EN 60529

ROLEC service

Avail of our Full Service Offer for installation-ready products

Configuration

If you have any questions or require individual configuration, your field service contact will be happy to assist

Suspension-System taraSMART



Type: Round tube $\varnothing 48$

Material-No.:
 144.510.250 (L= 250 mm)
 144.510.500 (L= 500 mm)
 144.510.750 (L= 750 mm)
 144.511.000 (L= 1000 mm)

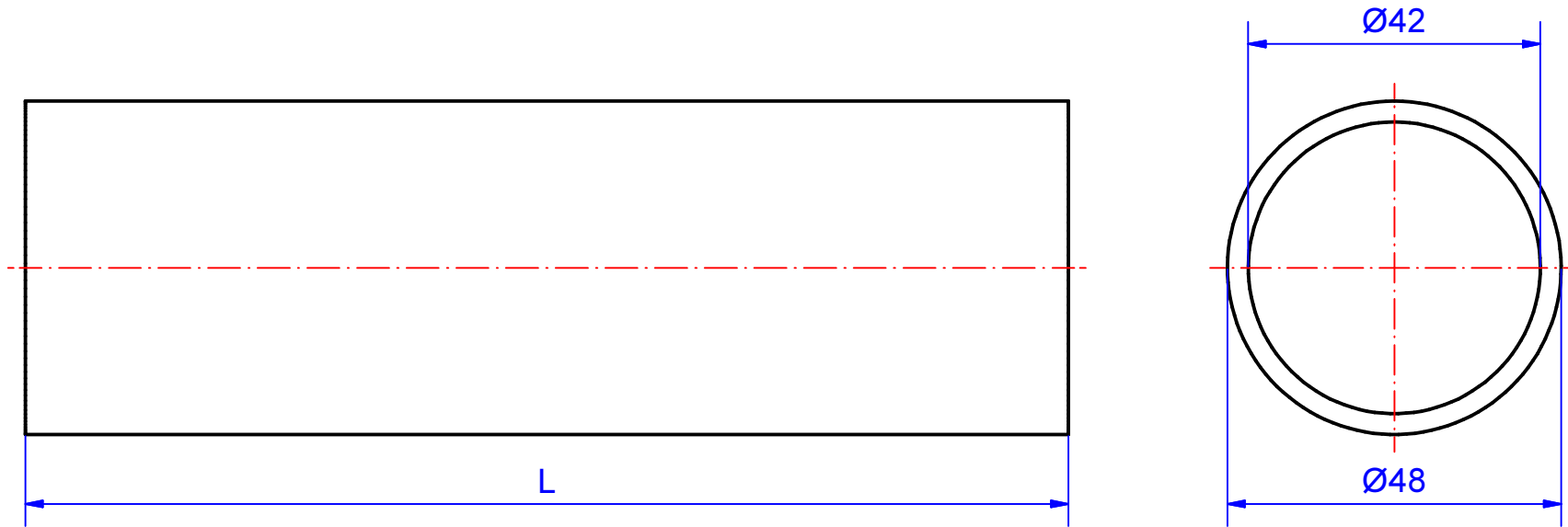

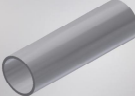
Material	Steel		Surface	Powder coating silver
Weight	3,3 kg/ m		Tolerance	Linear dimension ± 1 mm, remaining dimensions EN 10305-4 (DIN 2391)