

Suspension-system taraPLUS

Type: Intermediate joint

Material-No.: 149.015.000

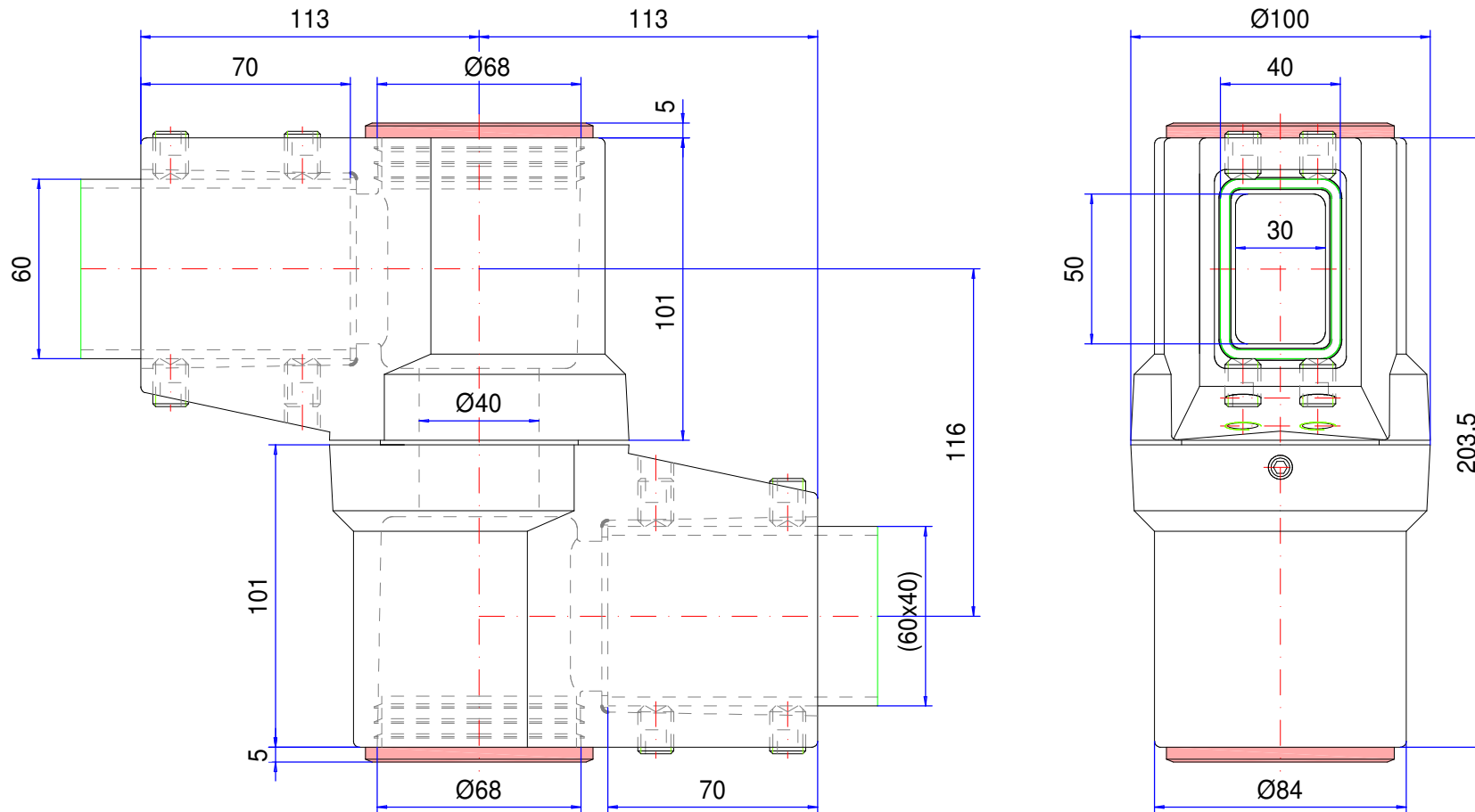

| | | | | |
|--------------------------|---------------------------|--|----------------|---|
| Material system elements | GK-Al Si 12 (DIN 1725) | | Pivoting range | 300° |
| Gasket | Chloroprene (CR), black | | Weight | 3,000 kg |
| Assembly screws | 16x M12, galvanized steel | | Coating | Powder coating RAL 7040, window grey |
| Ingress protection | IP54 EN 60529 | | Tolerance | GTA 14/5 DIN 1688-3 (outside dimensions ±0,8mm) |